

PIN TYPE SLIP RING
OD: 32mm

Description

Pin Type Slip Ring REC - Model RC32 Series OD: 32mm

RC32 Series pin type slip ring can be used in any electromechanical system that is requiring unlimited, continuous rotation for transmitting signal son any system. With a case diameter as 32 mm, the product can be easily mounted on any and pointor in any structure. The body structure of the product as aluminium or ABS, has easy assembling. The product is designed for industrial using and has IP65 protection class. Generally it can be used instead of mercury slip rings. These products, which are mercury-free, are preferred tousein the production and packaging machines in the factory which complies witht he EU environmental standards in terms of high IP classes With the help of PIN type termination the product can be easily mounted. It has alternatives up to 56 contacts in different case diameters. Fiber brushes doesn't need lubrication or main tenance and be a reason for a brasion for life long using. This type of slip rings uses a bunch of fiber brush technology in the ring and a few of the brushes and rings contact is provided on a point. This ensures long life and uninterrupted transmission.

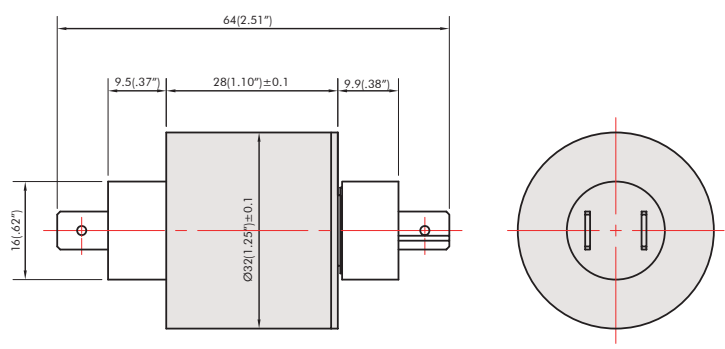

Sizes mm (inc)

Standart Product List of RC32 Series

Models	Body (mm)	(L=mm)	Pin Thickness x Width	Rated Current		Number of Total Circuit
				S(2A)	P(15A)	
RC32.P0215	32	28	0.8×6.3	-	2	2
RC32.P0315	32	28	0.8×6.3	-	3	3
RC32.P0215.S0202	32	28	0.8×6.3 - 0.8×2.8	2	2	4

Features

Outer Diameter: 32 mm. It has 2 to 4channels, can be produced as 56 channels for specificapplications. It can be combined as 2 and 15amperage and multiples on power circuits.It provides 400 rpm speedity.It has gold contacts, stainless steel body.

Options

Mechanical Design, Options of Flange, IP Classes, Operating Temprature, Different Current Value Options, Body Structure as AL and ABS, Military Standards

Electrical Information

Features	Values
Rated Voltage	240VDC/240VAC
Dielectric Strength	500VAC@50Hz, 60S
Insulation Resistance	1000MQ/500VDC
Electrical Noise	≤10mΩ

Mechanical Information

Features	Values
Operating Speed	0~400rpm
Operating Temperature	-20°C - +80°C
Operating Humidity	60%RH or more
Contact Material	Precious Metal
Frame Material	Engineering plastics
IP Class	IP51

*For more information about how REC slip ring capsule can fit your specific application, contact our slip ring experts.